

AS70-B-165 - SPEEDLINE System Data Sheet - Version V1 (24-10-23)

SPEEDLINE 70mm Acoustic 'C' Stud Partition
 @600mm Ctrs, with Inner BG Gyproc 12.5mm
 SoundBloc, Outer BG Gyproc 15mm DuraLine
 each side

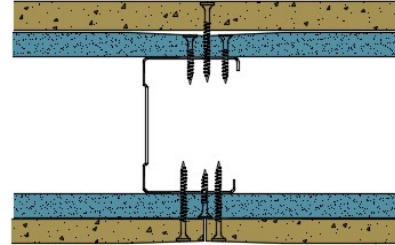

System Performance Breakdown

Fire Resistance:

BS476 Part 22:1987:

Test Ref & Date or Applied Ref & Report:

Max Height:

Thickness:

Duty Grade: BS 5234: Part 2:1992:

Sound Insulation:

60/60 Minutes (Integrity/Insulation).

BTC 17580F - BRE Report P102396-1011A

Refer to Speedline Specification Clause

127 mm. (At Base Track, Excluding Finishes)

Severe - Annexes A-F

53 R_w dB, Date Tested or Assessed Against - 15/07/2011

Test Code:
H17489AA
Test Date:
15/07/2011

Freq. Hz	R dB
50	26.8
63	15.0
80	16.4
100	28.1
125	30.0
160	36.1
200	44.8
250	42.3
315	46.4
400	50.1
500	53.6
630	53.3
800	57.8
1000	59.9
1250	61.4
1600	63.5
2000	60.6
2500	54.8
3150	55.3
4000	56.7
5000	58.5
6300	
8000	
10000	

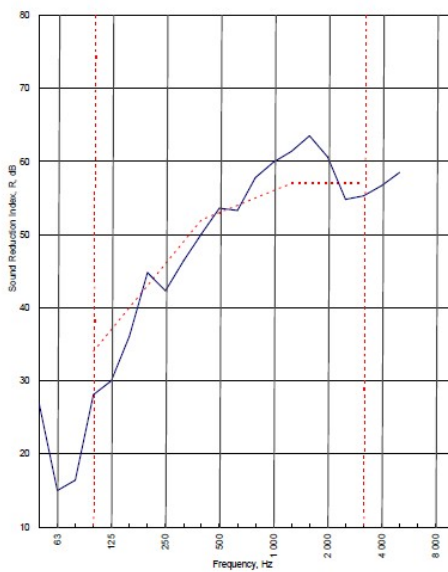

Rating according to BS EN ISO 717-1:1997 **R_w (C;Ctr) = 53 (-3;-8) dB**
 Max dev. 7 dB at 125 Hz

Evaluation based on laboratory measurement results obtained by an engineering method:

$C_{50-3150}$ = -8 dB	$C_{50-5000}$ = -7 dB	$C_{100-5000}$ = -2 dB
$C_{125-3150}$ = -19 dB	$C_{125-5000}$ = -19 dB	$C_{100-10000}$ = -8 dB

TESTED AT ONE OF THE UKAS ACCREDITED LABORATORIES BELOW

B.T.C (H-Ref on Graph)

B.R.E

AIRO

S.R.L

Customer: Metsec plc Hepsec Division

BTC 17489A: Page 8 of 10

